



SIGNATURE
ESTATES

Stocks Road

Tring, HP23 5RU

Asking Price £1,300,000

Welcome to Yew Cottage, a charming Grade II-listed cottage dating back to the 17th Century that oozes character. This property has everything you could wish for; four double bedrooms, three bathrooms, and fabulous gardens. A quintessentially British country village with excellent amenities and great access to London. Open views over the Ashridge forest, surrounded by leisure facilities and outdoor activities to suit your every whim and fill your weekends with adventure or relaxation.

- Charming Grade II Cottage
- Abundant Character
- Spectacular Views
- Stunning Inglenook
- Three Separate Garden Areas
- Quintessential English Village
- Over 2200 sq ft
- Must Be Seen

Viewing

Please contact our Bovingdon Office on 01923262666 if you wish to arrange a viewing appointment for this property or require further information.

SIGNATURE
ESTATES



4



3



4



E

Floor Plan

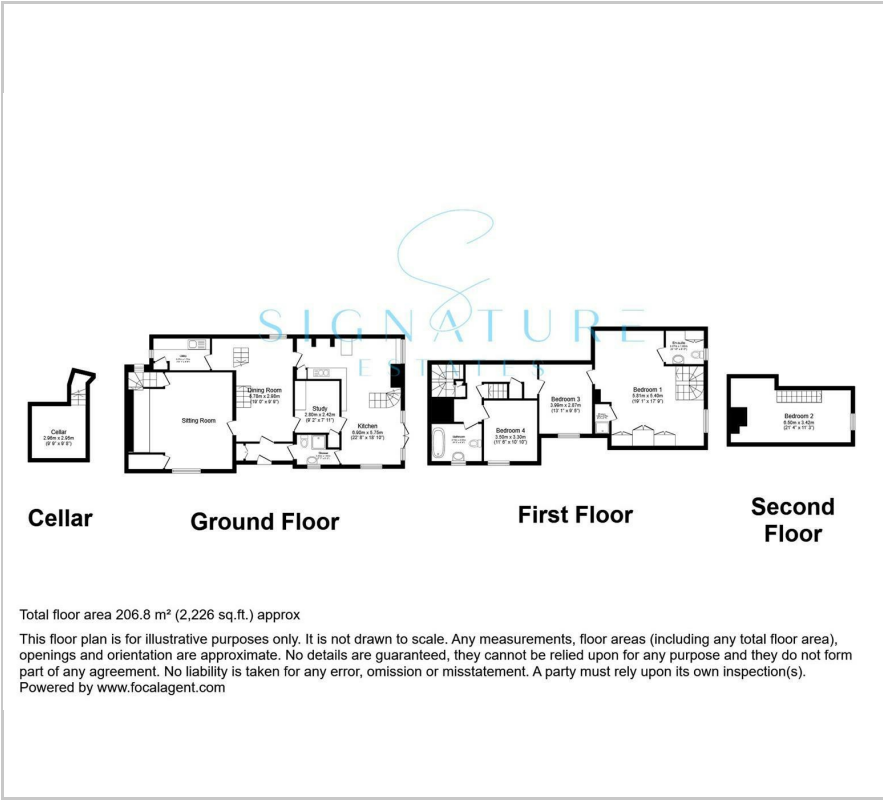

Area Map



Energy Efficiency Graph

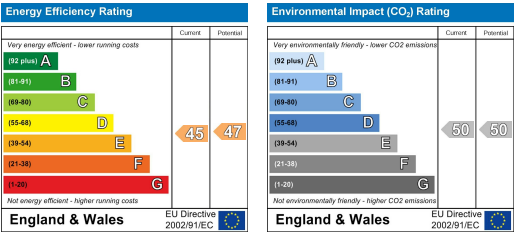

These particulars, whilst believed to be accurate are set out as a general outline only for guidance and do not constitute any part of an offer or contract. Intending purchasers should not rely on them as statements of representation of fact, but must satisfy themselves by inspection or otherwise as to their accuracy. No person in this firms employment has the authority to make or give any representation or warranty in respect of the property.